



# ISM-MC7000 SERIES

## Smart Mortise Entry Sets

- BHMA/ANSI Grade 1, UL 3-hr fire rated commercial mortise lock that can be remotely locked, unlocked, and programmed using smartphone or BLE/WIFI gateway
- Intuitive mobile INOX app supports multiple users and properties with real time access management
- Entry function with easily programmable Privacy and Passage modes with optional mechanical key override
- The Patent Pending lock is installed without special door prep and is battery powered

### APPLICATION

INOX ISM7000 BLE mortise lock is a perfect gateway solution across various applications

An entry lock for apartment unit, gym, laundry or office doors for multi-family/mixed-use properties, multi-tenant offices, retail/commercial facilities, or high-end residential entry doors

### SECURITY COMPLIANCE

- Backend IoT PaaS complies with domestic and international information security standards, privacy and compliance requirements
- Backend IoT PaaS security covers data and cloud services



### FINISH

- 32D Satin Stainless Steel
- 32 Bright Stainless Steel
- 19G Graphite Black
- PVD4 Satin Brass (205, 221, 243, 244, 276, 320, 321 and 346 levers designs)
- CeraMax Ceramic Coating: C19G Graphite Black, C19 Flat Black, CGY Stormy Grey, CDB Dark Bronze
- Please see Finish Solutions on INOX website for special order finishes

### FEATURES

- Motor-driven deadbolt provides auto-locking function
- Multi-credential support: Passcodes, RFID FOB/Card/ Wristband, and Smart Phone
- Remote access using Wi-Fi or POE gateway
- High Frequency RF13.56 MHz card, fob, wristband
- Passage mode can be activated with interior button
- Unit powered by 4 x AA alkaline batteries with secondary 9V power source for emergency access
- Remote Access and Management via Wi-Fi and Low Energy Bluetooth
- Digital Touchscreen Keypad
- User Capacity: 2000 Total (1000 RF/Passcode and 1000Mobile)
- Cloud-based APP with multi-level user roles
- Real-time Audit trail and backup email

### DIMENSIONS

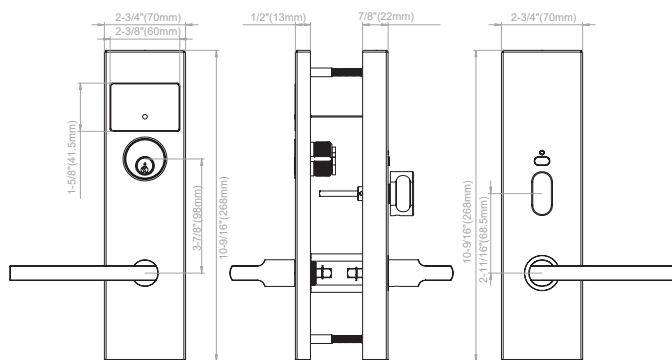



## APP CAPABILITIES

- Multi-level user Access and Permission Management
- Remote Locking and Unlocking via BLE/WIFI gateway
- Device Management and Personalization
- Do Not Disturb and DND Override functions
- Bluetooth mobile Locking and Unlocking
- Global Search function
- Account Management and Settings
- Property and Door Information Management
- Cloud-based encrypted authentication
- 2-step verification for added security
- Additional Bluetooth and Secure RFID credentials
- App and Web-based solutions

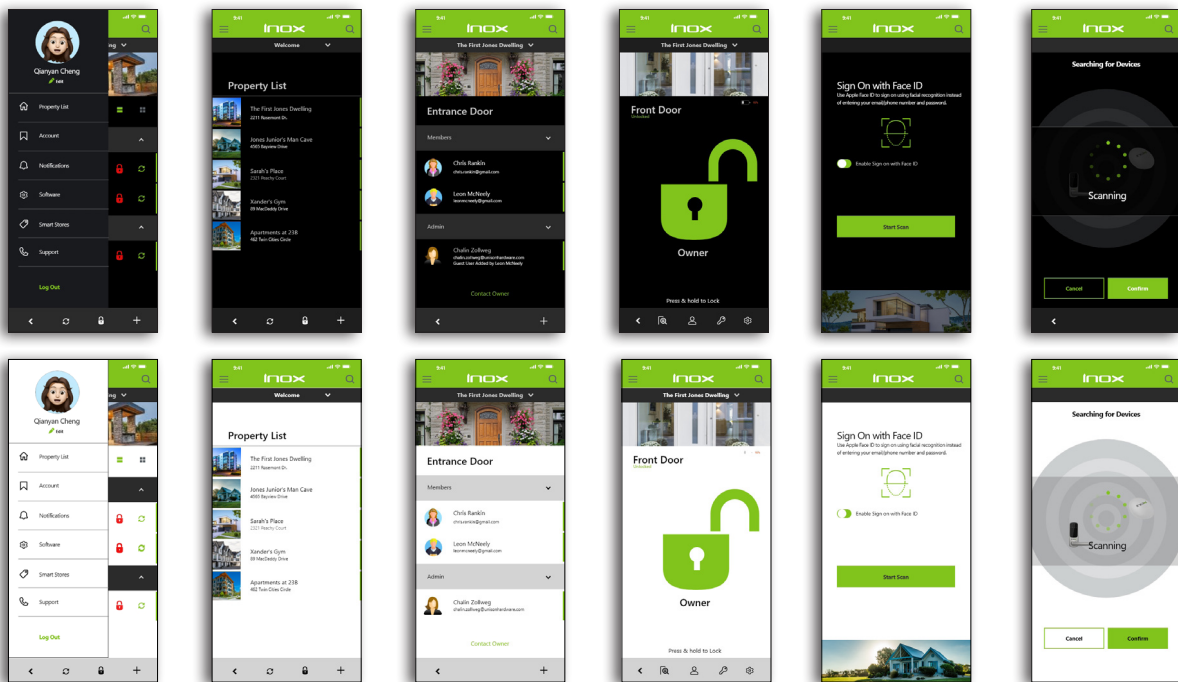

Download the INOX SMART App



# ISM7000 SMART MORTISE ENTRY SET

## LOCK SPECIFICATIONS

**Lockcase Backset** 2-3/4" (70mm)

**Center to Center Distance**  
Lever to Cylinder: 3-7/8" (98mm)

Lever to Thumbturn: 2-11/16" (68mm)

**Handing** Specify handing when ordering

**Cylinder** Schlage C keyway 6 pin, 1-1/4" mortise cylinder with 2 keys (standard). Optional SFIC and LFIC housing and cores available

**CAM** CAM01-SCL Clover Cam

**Material**  
Trim: Stainless Steel  
Lockcase: Heavy gauge Steel  
Bolt: Brass and Stainless Steel  
Faceplate/Strike: Stainless Steel  
Cylinder: Solid Brass

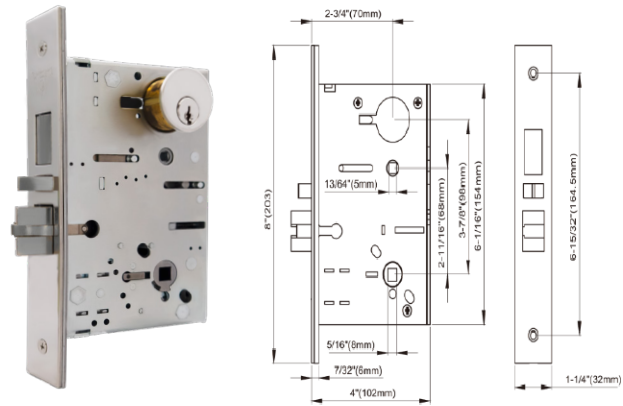

## CODE COMPLIANCE

- ANSI/BHMA A156.13 Grade 1 Mortise Lock
- UL Listed for 3 hour fire doors
- CAN/ULC S104 up to 3 hours
- UBC Standard 7-2 (1997) NFPA 252
- NFPA 80 National Fire Protection - Fire Door Assembly
- NFPA101 National Fire Protection - Life Safety
- ANSI A117.1 ADA Accessibility

## COMPONENTS

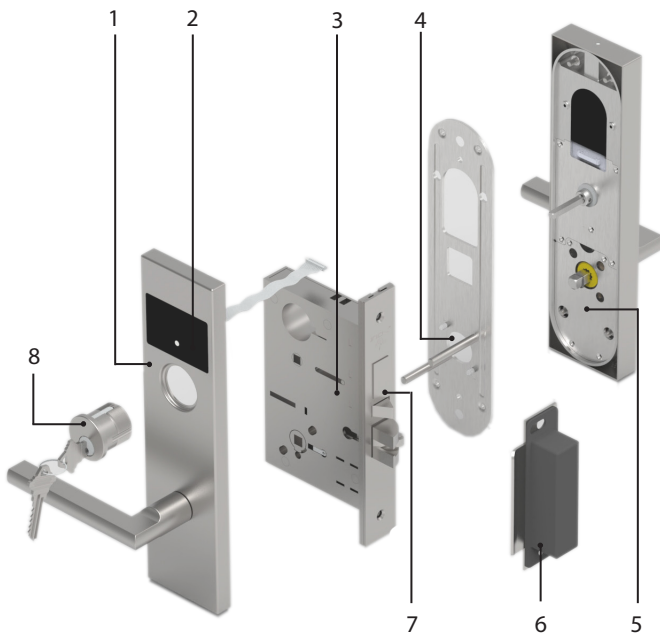













### Description

- 1 Exterior heavy-duty stainless steel cast plate with choice of X Series lever designs
- 2 Glareless Viewing Portal
- 3 ISM7000 lockcase and faceplate; 2-3/4" backset
- 4 Interior sub-plate
- 5 Interior heavy duty stainless steel cast plate with choice of X Series lever designs
- 6 1/4" (6.35mm) adjustable strike
- 7 1" (25.4mm) heavy-duty deadbolt
- 8 Schlage C keyway, 6 pin 1-1/4" mortise cylinder **CMB1146**

# HOW TO ORDER ISM7000 SMART MORTISE ENTRY SET

## HOW TO ORDER LOCKSETS

Use the sequence below to order or specify mortise locksets. Please see price book for parts or additional service upcharges.

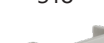
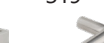
INOX Smart Mortise	Plate	Lever	Lock	Reader/Writer	Cylinder	Thumbturn	Finish	Handing
<b>ISM</b> <b>1</b>	<b>SFR</b> <b>2</b>	<b>243</b> <b>3</b>	<b>-MC7438</b> <b>4</b>	<b>BRW</b>	<b>5</b>	<b>6</b>	<b>32D</b> <b>7</b>	<b>LH</b> <b>8</b>
<b>PLATE</b>		<b>LEVER</b>			<b>LOCK</b>			
		 201  202  205  221  243  244  276  318  319  320  321  345  346  509			Deadbolt Entry without Toggle MDP Mortise Dummy Pair			

### 5 CYLINDER AND HOUSING (INCLUDES COLLAR)

LC = Less Cylinder



Blank = Standard Mortise 1-1/4" Cylinder



-S6 = Small Format Interchangeable Cylinder (SFIC) Housing 1-1/4", 6-Pin, Less Core, L Clover Cam

-S7 = Small Format Interchangeable Cylinder (SFIC) Housing 1-3/8", 7-Pin, Less Core, L Clover Cam

-L6 = Large Format Interchangeable Cylinder (LFIC) Housing 1-1/2", 6-Pin, Less Core, L Clover Cam



Order IC Cores and Thick Door Kits (TDKs) separately - See Price Book

### 6 THUMBTURN



TT02



Blank = TT04

### 7 FINISH

Standard:



32D



C19G



C19



CGY



CDB



32



PVD4



19G

*PVD4 finish available in the 205, 221, 243, 244, 276, 320, 321 and 346 lever design*

### 8 HANDING

RH = Right Hand

LH = Left Hand

RHR = Right Hand Reverse

LHR = Left Hand Reverse