

ISGW-BZ31

PLUG-IN GATEWAY

A compact plug-in gateway signaler that allows Access Control from anywhere with a functioning Wi-Fi signal.



DIMENSIONS

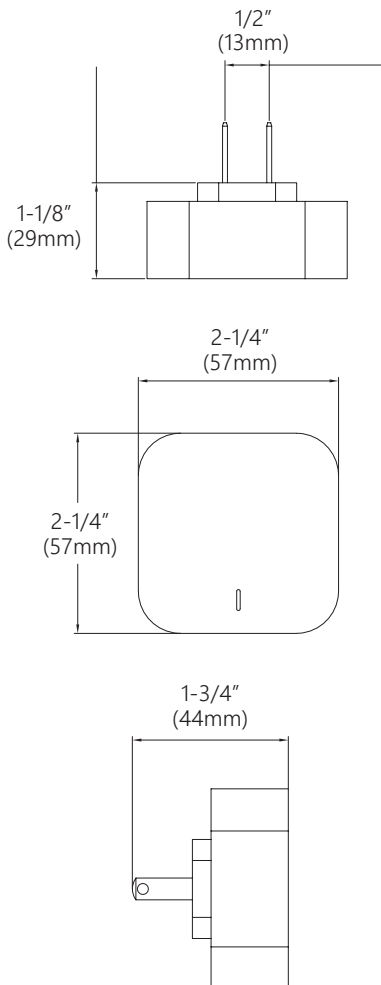

FEATURES

- The gateway can be plugged into any standard 110V outlet
- Supports up to 4 smart devices simultaneously; however, for optimal performance, it is recommended to connect no more than 2 smart devices at a time
- The gateway enables remote access via the INOX APP when connected to 4G, 5G, or the Internet
- Requires a 2.4 GHz network for connectivity
- The gateway has a coverage range of **30 feet with a clear line of sight**, meaning there are no walls, doors, or other physical barriers obstructing the direct path between the gateway and the Smart device

SPECIFICATIONS

Communication Protocol	BLU: Bluetooth Wi-Fi: Wireless Zigbee: Wireless Personal Area Network
Protocol Specs	BLU: 4.2, 802.11n Wi-Fi: 802.11bgn Zigbee: 3.0 IEEE 802.15.4
Wi-Fi LED (Red)	Blinking: Configuration mode Off: No network connection On: Connected to network
Pairing LED (Blue)	Blinking: Adding sub-device mode On: Gateway configured <i>Press and hold the button for 5 seconds until the red LED blinks, the gateway will enter the configuration mode.</i>
Power Input	110V US Outlet
Operating Temperature	14°F to 122°F
Dimension	2.2" L x 2.2" W x 0.9" H

If configuring Inox Smart Lock/Gateway with a Wifi Network with a Security Barrier (such as a firewall), please contact INOX Smart Technical Support for Port Forwarding Information.