

ISTH-HUK

SMART TUBULAR ENTRY HANDLESET

The INOX APP paired with our smart touchscreen keypad, manages multiple users and properties with real-time access control to provide enhanced security and convenience at your fingertips.



CODE COMPLIANCE

- ANSI/BHMA Grade 2
- UL Listed for 3 hour fire doors
- NFPA 80 National Fire Protection (Fire Door Assembly)

FINISHES

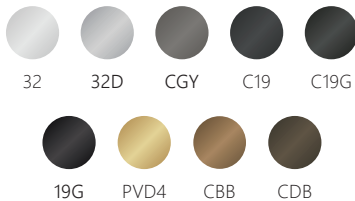

FEATURES

- BHMA/ANSI Grade 2, UL 3-hr fire-rated TL5 latch and fire-rated tapered bolt
- Elegant Full Plate Handleset design featuring sturdy Pull Handle and Backlit Keypad
- Use the INOX Smart App to manage users, track access, and customize settings remotely from your smartphone
- Set timed auto-locking and activate Privacy Mode for added security
- Built for exterior use with stainless steel construction and weather resistant seals with standard exterior gasket, and additional interior gasket available to order
- Additionally compatible Door Positional Sensors (DPS) for wood or metal doors available to order

SPECIFICATIONS

Door Thickness	1-3/4" (45mm) Standard Thick Door Kit available
Backset	2-3/8" (60mm) standard 2-3/4" (70mm) optional
Center-to-Center Distance	Lever to Cylinder: 5-1/2" (140mm)
Cylinder	1" RIM Cylinder (CRB105) 5-pin Schlage C Keyway with 2 keys
Leverset Thru-bolts	2 EA M4x35mm
Deadbolt Thru-bolts	2 EA M5x50mm

FEATURE CALLOUTS

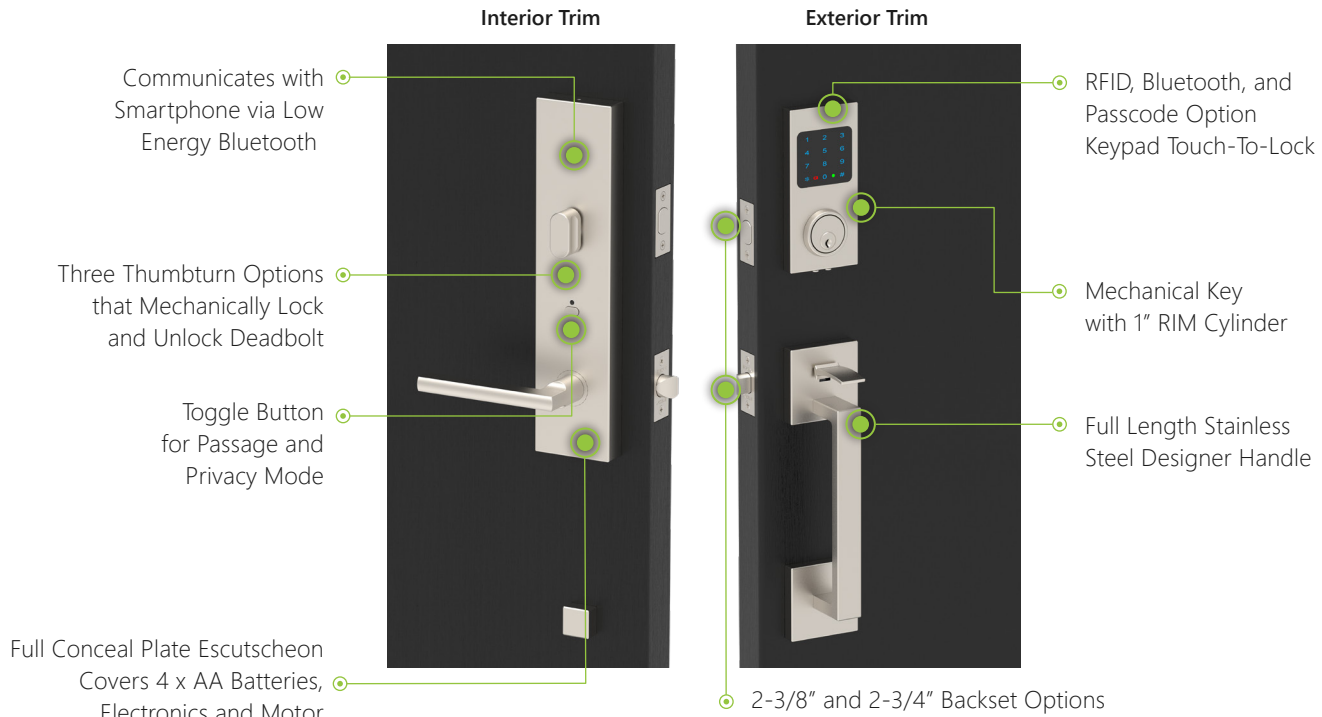

APP CAPABILITIES

User Capacity for Keypad: 2000 users (1000 RFID/1000 Mobile)

Supports multi-credential access with High Frequency RFID 13.56 MHz cards, FOBs, wristbands, and smartphones

Remote Locking and Unlocking via BLE/Wi-Fi gateway

Audit trails with 100,000 records shows all Lock and Unlock activities

Add, remove, edit, and schedule RFID credentials/user access down to the exact hour/min

Passcode option on Keypad (4, 6, 8 digit passcode length)

Purchased Door Position Sensor (DPS) w/ cloud monitoring features available on the App

Supports three types of Keypad passcodes: auto-generated, user-defined, and 24-hour one-time validation codes

Property and Door Information Management & Cloud-Based Encrypted Authentication

2-Step Verification Available for Added Security

Over The Air (OTA) Firmware Updates

Notification on locking abnormalities and battery level

Global search function with App and web-based solutions

Filter property user lists by active or inactive status to view permission

Control multiple locks in the same space, expanding beyond previous single-lock limitation

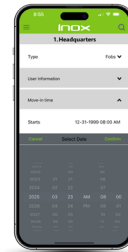

Precise Scheduling

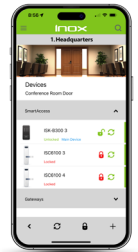

Devices Panel

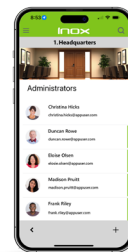

User List

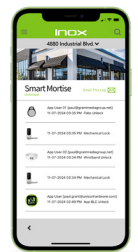

Audit Trail

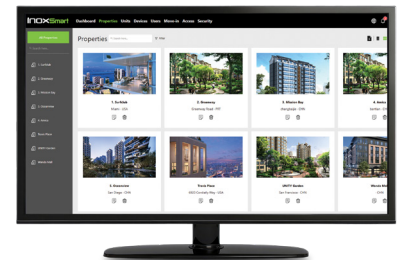

Web Portal



Download the INOX Smart App today!



DIMENSIONS

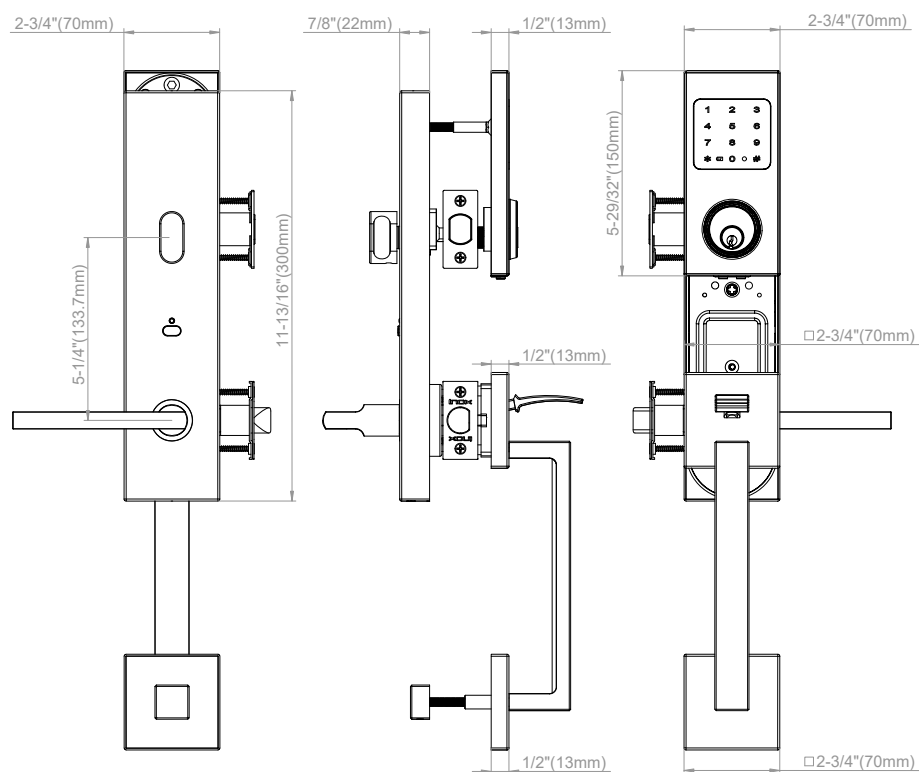

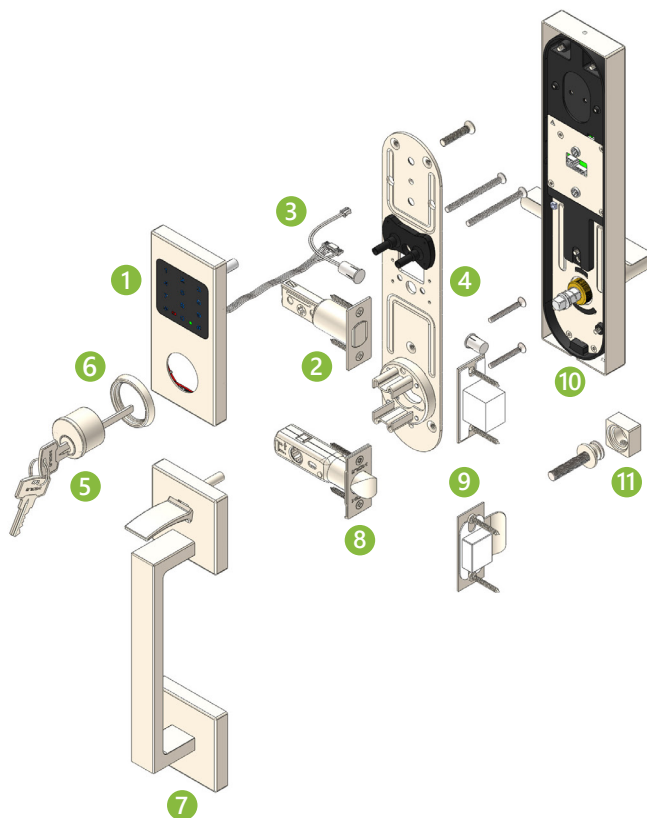

COMPONENTS

- 1 Touchscreen keypad
- 2 Deadbolt with anti-drill pin
- 3 DPS - Door Position Sensor (Optional)
- 4 Tubular Interior sub-plate
- 5 Schlage C keyway, 1" RIM Cylinder
- 6 6mm Collar
- 7 Exterior heavy-duty stainless steel cast plate with sturdy Pull Handle
- 8 TL5 Latch
- 9 Standard Strike for Latch and Bolt
- 10 Interior heavy-duty stainless steel cast plate with choice of X Series lever designs
- 11 Interior bolt that connects to the Exterior plate

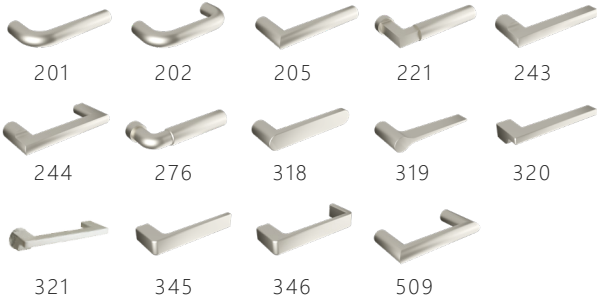

HOW TO ORDER STANDARD LOCKSETS

Use the sequence below to order or specify mortise locksets. Please see price book for parts or additional service upcharges.

INOX SMART	HANDLESET	LEVER	BACKSET	CYLINDER	CENTER-TO-CENTER	THUMBTURN	FINISH	HANDING
ISTH 1	-HUK 2	243 3	-C573FT 4	5	-CT5 6	-TT02 7	32D 8	-LH 9
PLATE		LEVER			BACKSET			
					<p>C563FT = 2-3/8" Backset (Fire Rated Launch) C573FT = 2-3/4" Backset (Fire Rated Launch)</p>			
ISD								
								
PULL								

6 CYLINDER AND HOUSING (INCLUDES COLLAR)

- LC = Less Cylinder
- Blank = Standard RIM 1" Cylinder (CRB105)

6 CENTER TO CENTER

- CT5 = 5-1/2" Center to Center

7 THUMBTURN

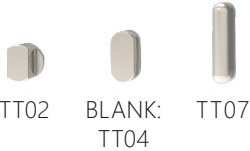

8 FINISHES* (STANDARD)

- 32D Satin Stainless Steel
- 32 Bright Stainless Steel
- 19G Graphite Black
- PVD4 Satin Brass
- Ceramax Graphite Black (C19G)
- Ceramax Flat Black (C19)
- Ceramax Stormy Grey (CGY)
- Ceramax Dark Bronze (CDB)
- Ceramax Burnt Bronze (CBB)

*Please see Finish Solutions on INOX website for special order finishes.

9 HANDING

- RH = Right Hand
LH = Left Hand
RHR = Right Hand Reverse
LHR = Left Hand Reverse