

IST

SMART TUBULAR INTERCONNECT

A commercial grade lock with built-in RFID reader and digital keypad offering smart access technology for residential and commercial entry doors in offices, multifamily and mixed use properties.



CODE COMPLIANCE

- ANSI/BHMA A156.13 Grade 1 Mortise
- UL Listed for 3 hour fire doors
- CAN/ULC S104 up to 3 hours
- UBC Standard 7-2 (1997) NFPA 252
- NFPA 80 National Fire Protection (Fire Door Assembly)
- NFPA101 National Fire Protection (Life Safety)
- ANSI A117.1 ADA Accessibility

FINISHES

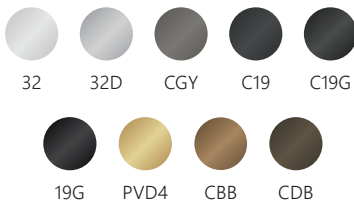

FEATURES

- BHMA/ANSI Grade 2, UL 3-hr fire-rated TL4 latch and fire-rated tapered bolt
- The interconnect design combines the added security of a tubular deadbolt with the single action egress
- Available in 4" and 5.5" center to center door prep and installation with motorized gears for deadbolt with keypad
- Backend IoT PaaS complies with domestic and international information security standards, privacy and compliance requirements

SPECIFICATIONS

Door Thickness	1-3/4" (45mm) Thick door kits available
Backset	2-3/8" (60mm) standard 2-3/4" (70mm) optional
Center Distance	4" (101mm) 5-1/2" (133mm)
Handing	Specify handing for all functions; latchbolt is field reversible
Hub & Spindle	5/16" (8mm) square
Latch Faceplate	1" x 2-1/4" standard square corner
Cylinder	1" RIM Cylinder, 2 keys included, Keying service available
Keypad	Digital Touchscreen

FEATURE CALLOUTS



APP CAPABILITIES

User Capacity for Keypad: 2000 users (1000 RFID/1000 Mobile)

Supports multi-credential access with High Frequency RFID 13.56 MHz cards, FOBs, wristbands, and smartphones

Remote Locking and Unlocking via BLE/Wi-Fi gateway

Audit trails with 100,000 records shows all Lock and Unlock activities

Add, remove, edit, and schedule RFID credentials/user access down to the exact hour/min
Passcode option on Keypad (4, 6, 8 digit passcode length)

Door positioning sensor (DPS) w/ optional cloud monitoring features available on the App

Supports three types of Keypad passcodes: auto-generated, user-defined, and 24-hour one-time validation codes

Property and Door Information Management & Cloud-Based Encrypted Authentication

2-Step Verification Available for Added Security

Over The Air (OTA) Firmware Updates

Notification on locking abnormalities and battery level

Global search function with App and web-based solutions

Filter property user lists by active or inactive status to view permission

Control multiple locks in the same space, expanding beyond previous single-lock limitation



Precise Scheduling



Devices Panel

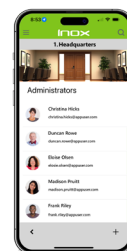

User List



Audit Trail

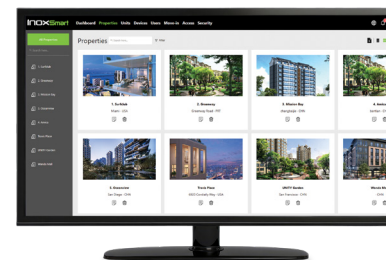

Web Portal



Download the INOX Smart App today!



DIMENSIONS

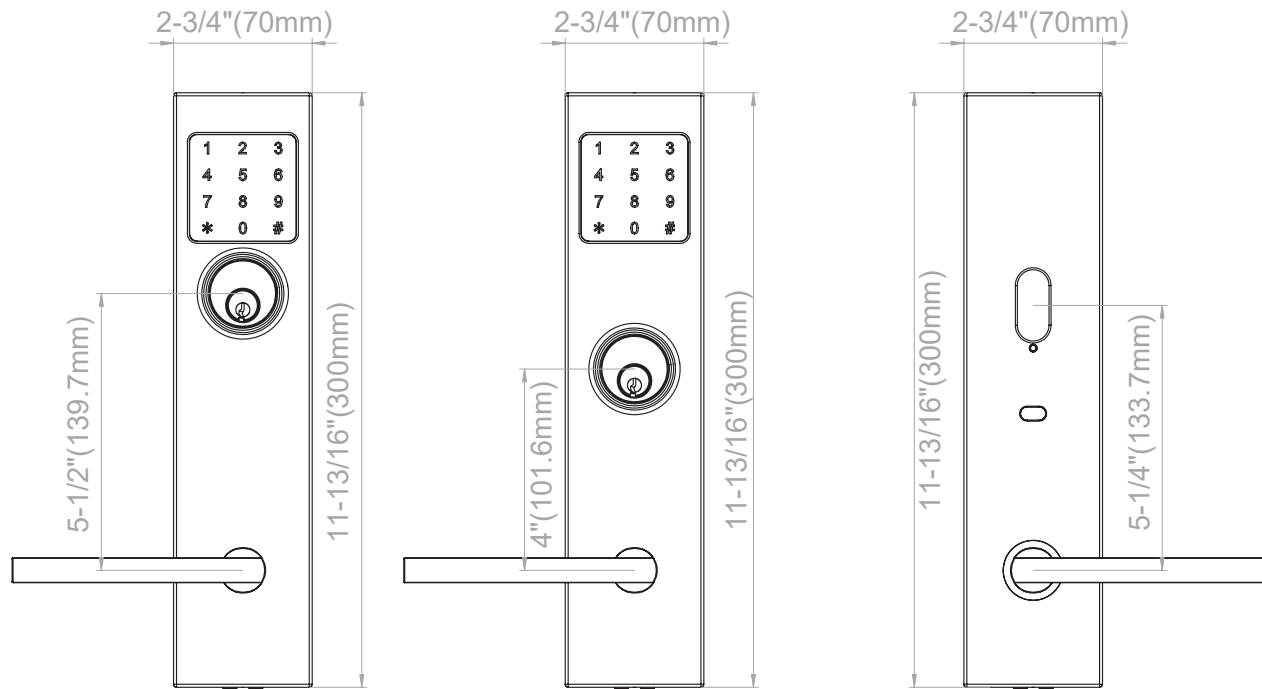

COMPONENTS

- 1 Touchscreen keypad
- 2 Deadbolt with anti-drill pin
- 3 DPS - Door Position Sensor (Optional)
- 4 Tubular Interior sub-plate
- 5 Schlage C keyway, 1" RIM Cylinder
- 6 6mm Collar
- 7 Exterior heavy-duty stainless steel cast plate with choice of X Series lever designs
- 8 TL4 Latch
- 9 Standard Strike for Latch and Bolt
- 10 Interior heavy-duty stainless steel cast plate with choice of X Series lever designs

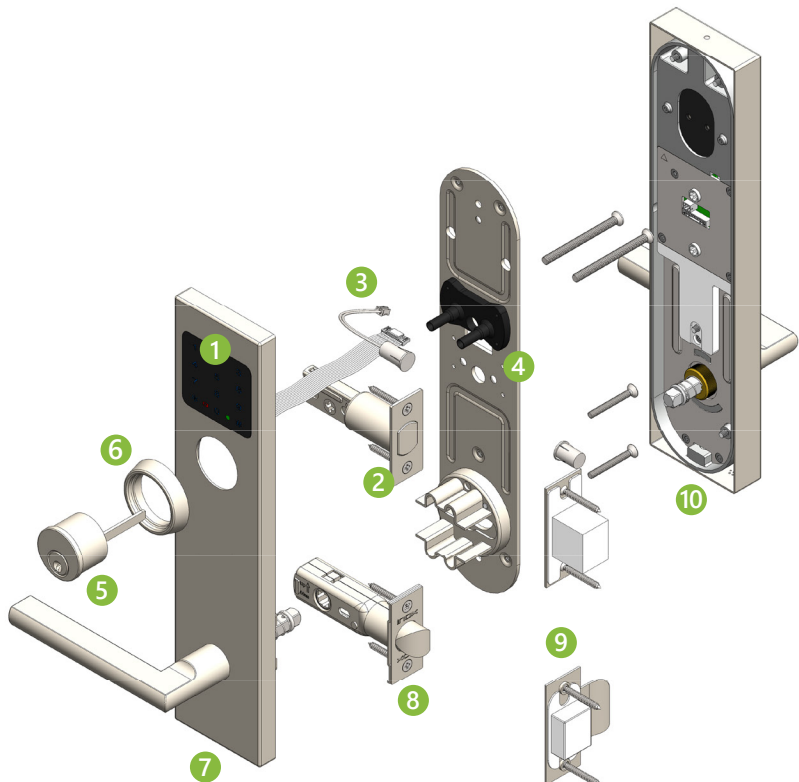

HOW TO ORDER

Use the sequence below to order or specify mortise locksets. Please see price book for parts or additional service upcharges.

INOX SMART TUBULAR PLATE LEVER BACKSET CYLINDER CENTER TO CENTER THUMBTURN FINISH HANDING

IST
①SFK
②243
③-C473FT
④

⑤

-CT5
⑥-TT02
⑦-32D
⑧-LH
⑨

PLATE



IST

LEVER

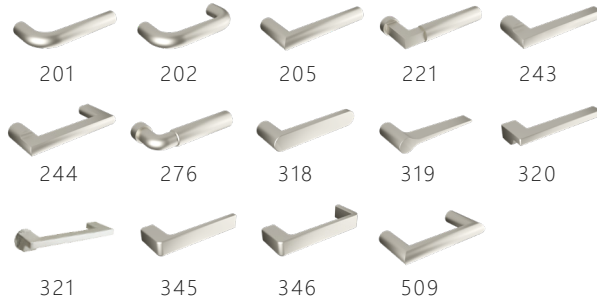

BACKSET

C463FT = 2-3/8" Fire-Rated Backset

C473FT = 2-3/4" Fire-Rated Backset

⑥ CYLINDER AND HOUSING (INCLUDES COLLAR)

- LC = Less Cylinder
- Blank = Standard RIM 1" Cylinder (CRB105)

⑥ CENTER TO CENTER

- CT4 = 4" Center to Center
- CT5 = 5-1/2" Center to Center

⑦ THUMBTURN

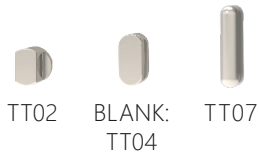

⑧ FINISHES* (STANDARD)

- 32D Satin Stainless Steel
- 32 Bright Stainless Steel
- 19G Graphite Black
- PVD4 Satin Brass
- C19G Graphite Black
- C19 Flat Black
- CGY Stormy Grey
- CDB Dark Bronze
- CBB Burnt Bronze

*Please see Finish Solutions on INOX website for special order finishes.

⑨ HANDING

RH = Right Hand

LH = Left Hand

RHR = Right Hand Reverse

LHR = Left Hand Reverse